

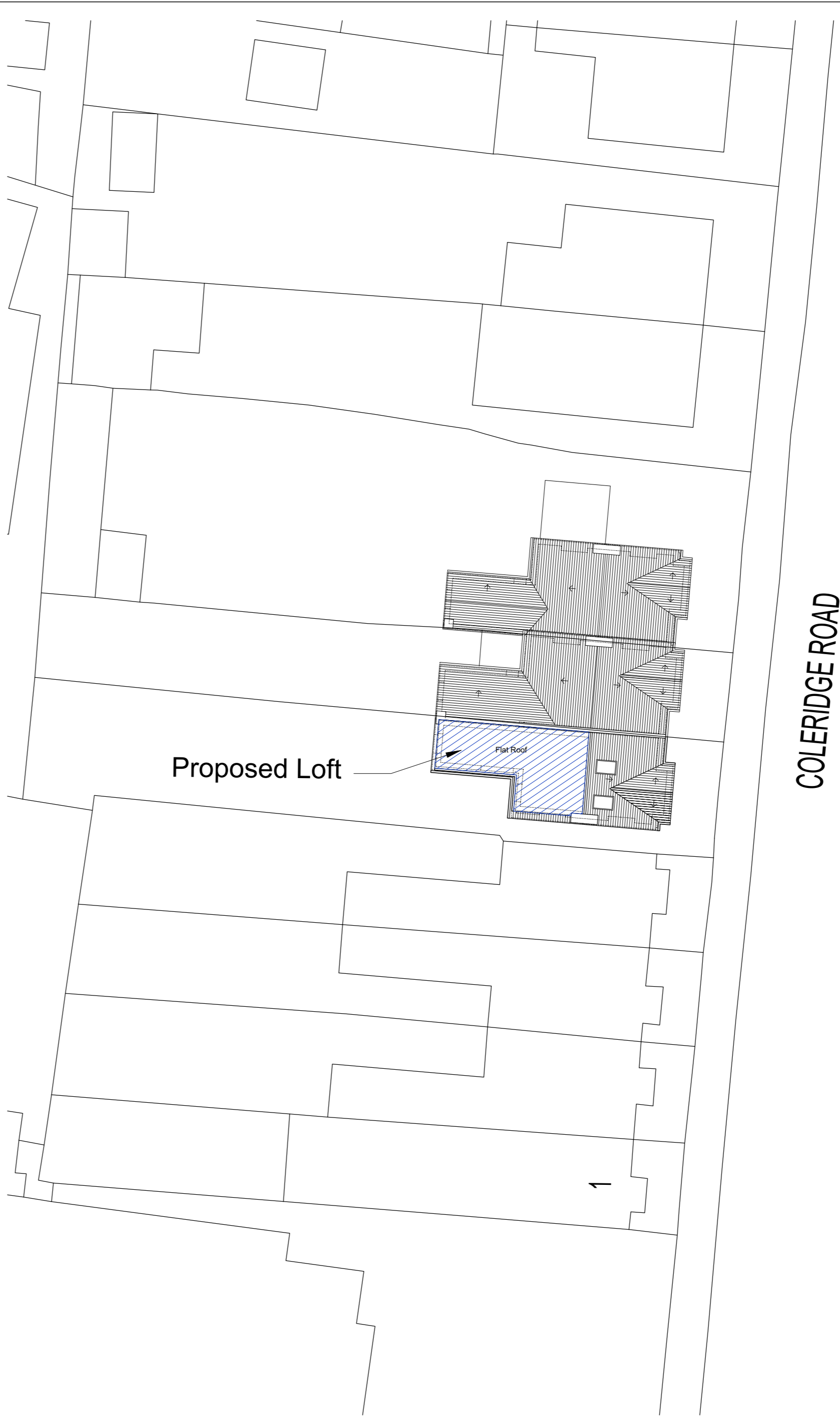

Block Plan
as Existing
1:200

COLERIDGE ROAD



Block Plan
as Proposed
1:200

COLERIDGE ROAD

Issue:
LDC

Revision:

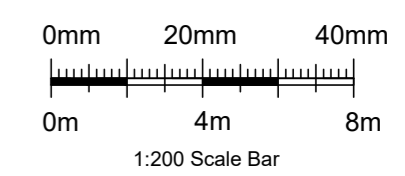
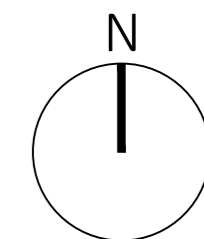

CG ARCHITECTS
36 Cannon Hill, London, N14 6LG
Tel: 020 8449 5100 | Fax: 020 8449 5170

Client:
Mr B. Evangeli

Site:
**9 Coleridge Road
Barnet
N12 8DH**

Title:
**Block Plan as
Existing and Proposed**

Scale: 1:200 @ A2	Drawn: RG	Drawn: CG
Date: Feb. 2025		

Drg. No. 1749/01	Rev. #
----------------------------	------------------